

Notes:

- Do not scale from drawing
- All dimensions in metres unless otherwise stated

Key:

— Limit of Work

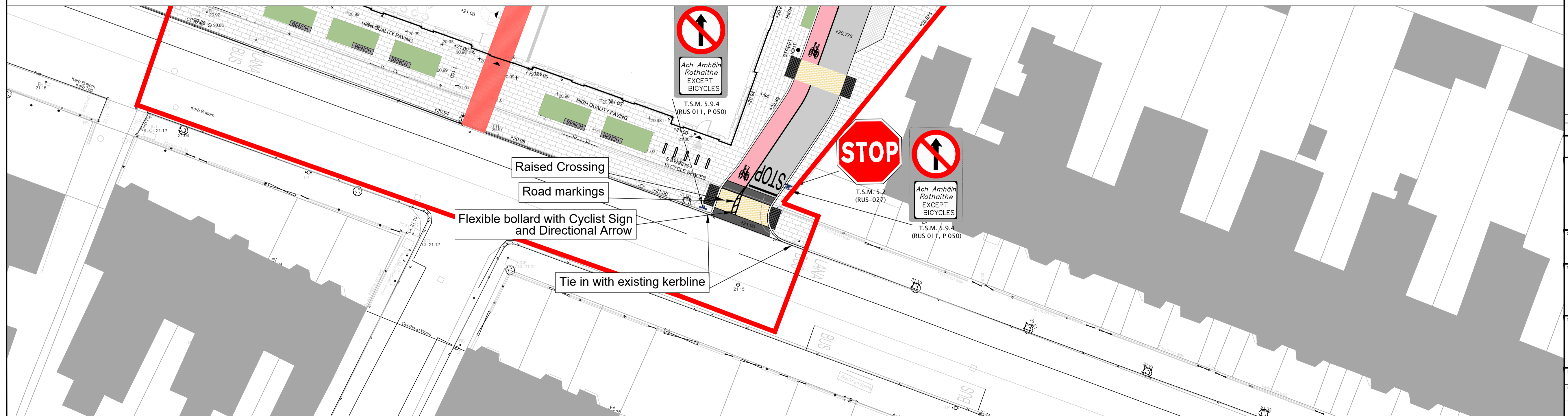

15	09/11/2020	UPDATED LAYOUTS	AMP	AM	AA
14	14/09/2020	FIRST ISSUE	AMP	AM	AA
Rev.	Date	Revision details	Drawn	Checked	Approved

© This drawing is the property of SYSTRA Limited and the information can only be reproduced with their prior permission.

**SYSTRA**  
www.systra.ie

2nd Floor, Riverview House  
21-23 City Quay, Dublin 2  
D02 FP21 Tel: +353 1 566 2028

Client: DBTR-SCR1 Fund, a Sub-Fund of the CWTC Multi Family ICAV

Project: Proposed Strategic Housing Development on the former Player Wills site and undeveloped land owned by Dublin City Council at South Circular Road, Dublin 8.

Title: EXTERNAL JUNCTIONS

Drawn	Checked	Approved
AMP	AM	AA
Original drawing size	Date	Scale
A1	December 2020	1:250
Drawing Status	Drawing Number	Rev.
FINAL	SYS-PW-01.2	C